

**Application for Waiver from Construction Standards for Public Water Systems**

Revised March 2025

Water System Name: Portland Water Bureau

PWS ID: 00657

Project or Facility: SE 21<sup>st</sup> Ave & Nehalem

County: Multnomah

Need for waiver identified: ☐ Water System Survey

Date of Survey:

☒ Plan Review # Exempt

Construction standard requested to be waived: OAR 333-061-0050 (9)(b) water sewer separation

As provided under OAR 333-061-0055, OHA may grant waivers from the construction standards prescribed by these rules:

- (a) When it is demonstrated to the satisfaction of OHA that strict compliance with the rule would be highly burdensome or impractical due to special conditions or causes; and
- (b) When the public or private interest in the granting of the waiver is found by OHA to clearly outweigh the interest of the application of uniform rules; and
- (c) When alternate measures are provided which, in the opinion of OHA, will provide adequate protection to the health and safety of the public including the ability to produce water which does not exceed the maximum contaminant levels listed in rule 333-061-0030.

Describe situation that conflicts with the standard. A proposed water pipe will cross (<45 degrees) over top of an angled existing sanitary sewer pipe. The sewer is >9' deep, creating a Zone 2 parallel conflict from 2+08 to 2+50.

Describe why meeting the standard is highly burdensome or impractical. Since the angled sewer crosses the entire right of way, the proposed water must cross it somewhere.

Describe proposed alternate measure that provide adequate protection to public health and safety. The proposed water pipe will be encased in CLSM for the segment where it is within 5' of the existing sewer.

**EMAIL this form along with plans of proposed waiver request and additional supporting information to your regulator or [dws.planreview@odhsoha.oregon.gov](mailto:dws.planreview@odhsoha.oregon.gov).** If you are unable to send your documents electronically, please contact OHA before mailing them.

Signature: 	Date: 04/18/2025
--	------------------

Name: Mac Gifford

Address: 1900 N Interstate Ave

City/State/Zip: Portland, OR 97227

Phone Number: 503-823-1507

800 NE Oregon St., Ste 640, Portland, OR 97232-2162

Voice: 971-673-0405 | Fax: 503-673-0694

All relay calls accepted | [www.healthoregon.org/dws](http://www.healthoregon.org/dws)

Email Address: mac.gifford@portlandoregon.gov

☐ Comments:

☒ Attachments (describe): Improvement plans for W03040 SE 21<sup>st</sup> Ave

**OHA Use Only**

Waiver ID: 530-2025

Entered into waiver database ☒

☒ Plan Review Coordinator's notes: Proposed encasement with CLSM is an appropriate remedy for the Zone 2 conflict.

After due consideration the above requested waiver from the construction standards of OAR 333-061-0050 is hereby:

☒ Approved      Comments:

☐ Denied

*Kari Salis*

April 21, 2025

Technical Services Unit or Regional Manager  
OHA Drinking Water Services

Date

Waiver database updated ☒

3/14/2025 2:27:14 PM \\wbf\file\group\Engineering\CAD\Projects\W03000 - W03999\W03040 - SE 21st Ave\W03040.dgn

# SE 21st Ave

## 6" DI Main

### Legend

	Existing	Proposed	Profile	Vicinity
Water Main	— W —	6"		
Connection to Main				
Gate Valve	— W —			
Reducer	— W —			
Blow-off Assembly	— W —			
Air Release	— W —			
Plug / Cap	— W —			
Insulating Joint				
Water Meter				
Thrust Block				
Tapping Sleeve and Gate Valve	— W —			
Fire Hydrant	— W —			
Cathodic Prot Test Stn				
Pressure Boundary				
Pressure Boundary to be Abandoned				
Electric (underground)	— E —			
Telephone (underground)	— T —			
Television (underground)	— TV —			
Gas Line (poly)	— G — 2" (P) —			
Gas Line (wrapped steel)	— G — 2" (W) —			
Gas Valve / CIV				
Sanitary / Comb Sewer	— S —			
Storm Sewer	— ST —			
Catch Basin Inlet				
Sanitary/Storm Manholes				
Edge of AC Pavement				
Edge of Gravel	— EG —			
Right of Way Line	— R/W —			
Curb	— curb —			
Sidewalk	— S/W —			
Test Bore				
Fence				
Ditch				
Stairway				
Utility Pole				
Mailbox				
Control Point				
General Note Reference				

### General Notes

- All work is to be constructed in accordance with the most recent version of the City of Portland Standard Construction Specifications, The Erosion Control Manual developed by the Bureau of Development Services, and the Oregon Administrative Rule (OAR), Chapter 333.
- ATTENTION:** Oregon law requires you to follow rules adopted by the Oregon Utility Notification Center. Those rules are set forth in OAR 952-001-0010 through OAR 952-001-0090. You may obtain copies of the rules by calling the Center. The Center business number is 503-232-1987. Excavators are required to notify the Center at least 2 business days, but not more than 10 business days, before commencing an excavation. To comply, call 811 or 1-800-332-2344.
- Concrete restoration shall be as follows:
  - All concrete in traveled roadway shall be class 4000-1½".
  - Miscellaneous concrete shall be class 3000-1½", unless otherwise specified.
- When crossing under a sanitary sewer or with less than 1½ feet clearance, notify the Portland Water Bureau (PWB) representative.
- Where ductile iron (DI) pipe crosses a main that is cathodically protected:
  - Center a full length of DI pipe over the crossing and sleeve the barrel of the DI pipe in schedule 80 PVC pipe and seal the sleeve ends with Fernco type coupling, per standard drawing P-770.
  - Where the piping configuration does not permit the above installation, wrap or encase the DI pipe in 40 mil reinforced PVC geomembrane for 20' length, 10' each side of the crossing, per standard drawing P-770. Fill around the geomembrane shall be sand or ¾" minus aggregate.
- Provide "As Constructed" drawings indicating all changes in grade, alignment, fittings and materials installed or any other utilities or obstacles not so indicated on these plans.
- Minimum hydrostatic test pressure shall be 150 psi at the point of the highest elevation of pipe being tested.
- Main shall have a minimum of 3 feet of cover from top of pipe to finished street grade, or as approved by the PWB representative.
- The PWB representative is Veronique Johnson, (971) 917-5536.

### Resurfacing Schedule

Aggregate paving base consists of ¾" - 0" to 1"-0" imported crushed aggregate. See Specifications.

Station	Existing	Classification	Replacement
0+00 to 2+80	AC on Aggregate Base	Local	Level 2, PG 64-22 AC with 3" AC on 8" aggregate base rock or match existing (whichever is greater) up to MAX 6" AC on 8" aggregate base. See Standard Drawing P-505.

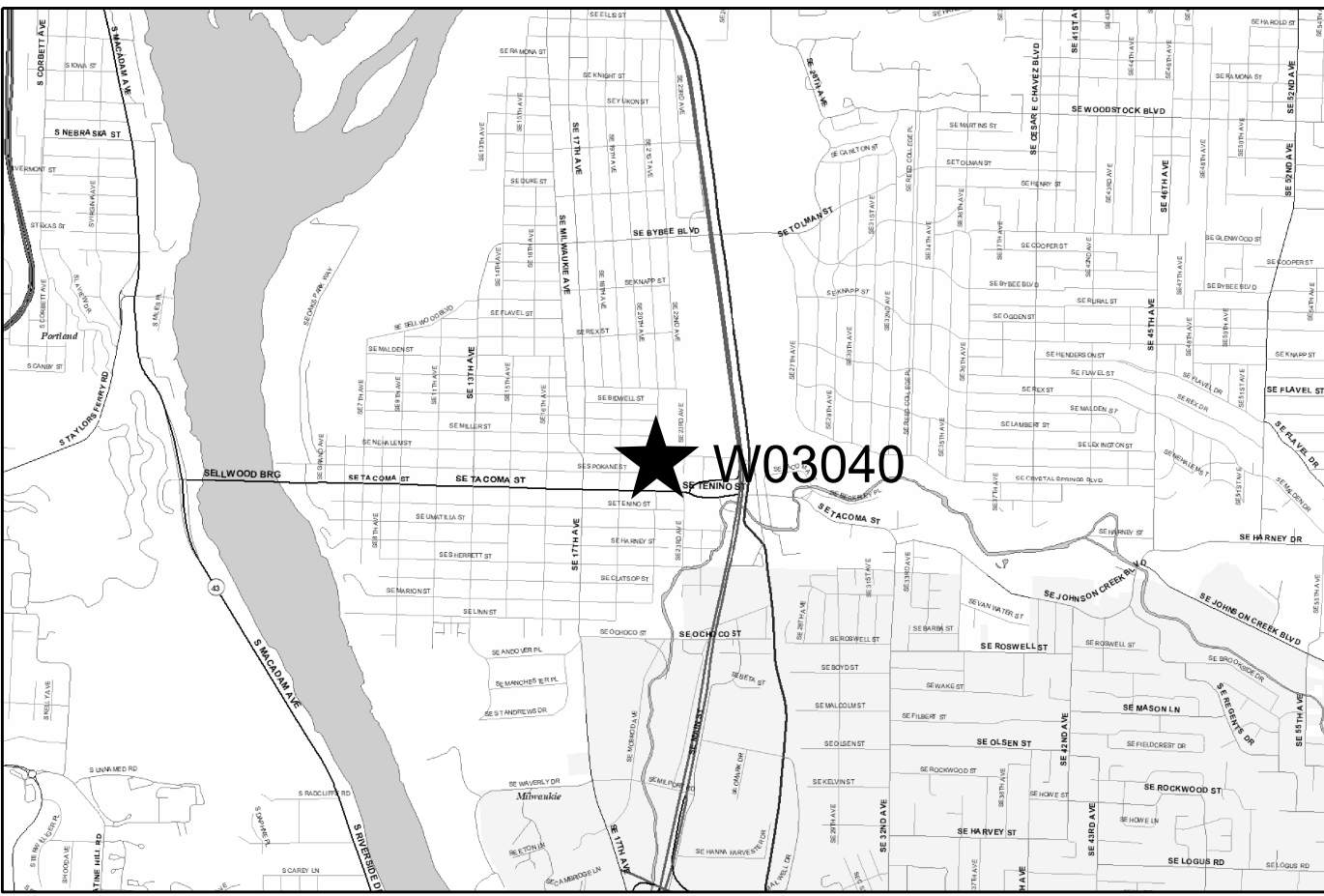

### Location Map

NTS

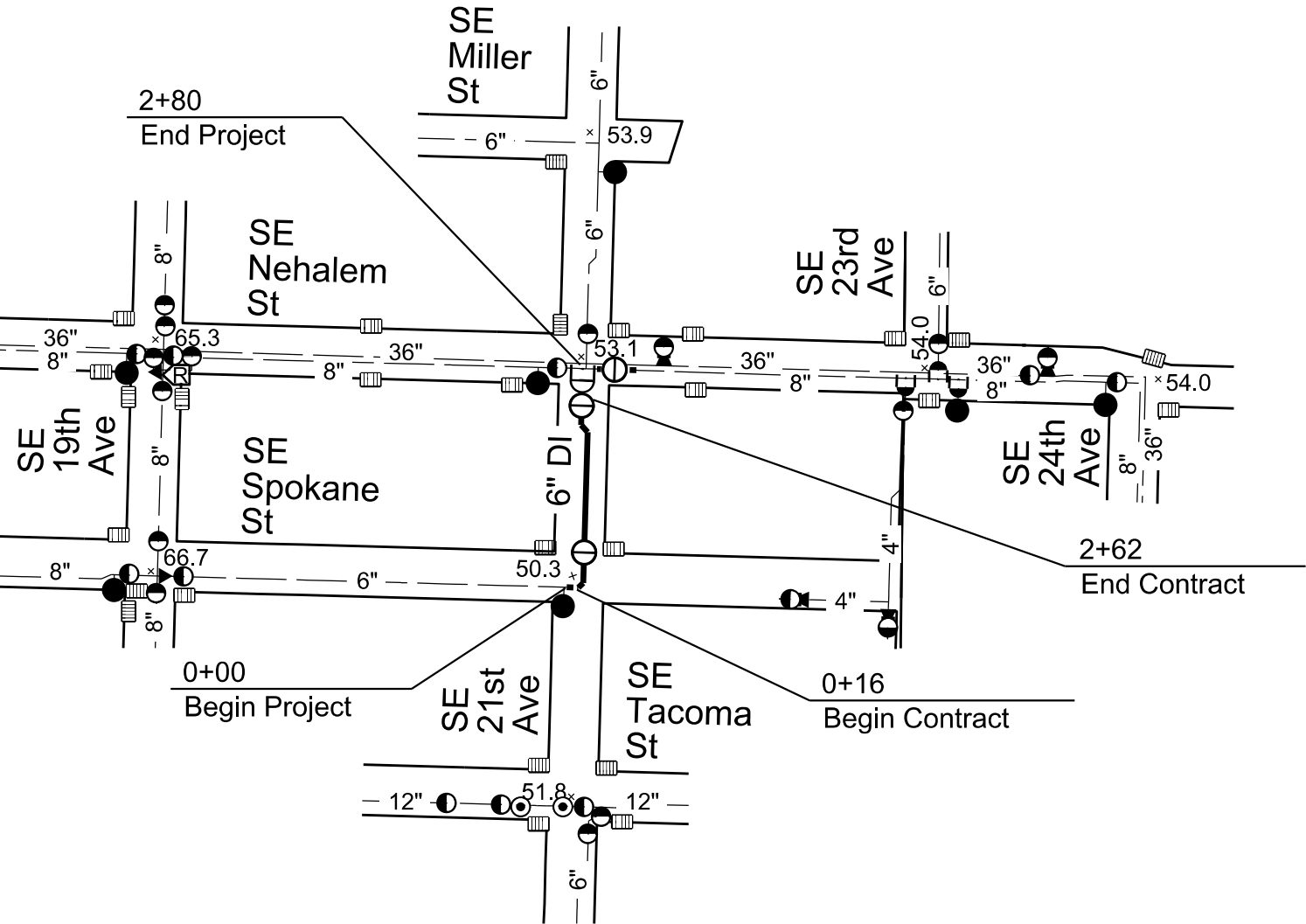
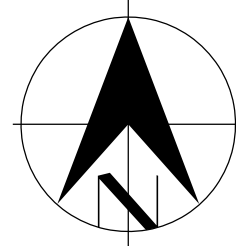



## Renew All Services

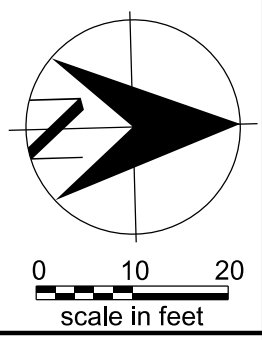

# Plan Sheet

2 of 2

No	Date	Description	Appd
Revision			
Survey	09 / 2024	ALCOVER	

Designed By	VJ	Program Mgr	KWW
CAD Checked By		Const Mgr	VJ
Checked By		Const Supvr	
Project Mgr	VJ	Date	



**Preliminary**

