

Application for Waiver from Construction Standards for Public Water Systems

Water System Name	Tualatin Valley Water District	PWS ID	00655
Project or Facility	C12913-SW 92 nd Ave (Greenburg to N Dakota)	County	Washington
Need for waiver identified:	<input type="checkbox"/> Water System Survey	Date of Survey	2/19/2025
	<input checked="" type="checkbox"/> Plan Review #		

Construction standard requested to be waived: OAR 333-061-0050 (9) (d)

As provided under OAR 333-061-0055, the Department may grant waivers from the construction standards prescribed by these rules:

- (a) When it is demonstrated to the satisfaction of the Department that strict compliance with the rule would be highly burdensome or impractical due to special conditions or causes; and
- (b) When the public or private interest in the granting of the waiver is found by the Department to clearly outweigh the interest of the application of uniform rules; and
- (c) When alternate measures are provided which, in the opinion of the Department, will provide adequate protection to the health and safety of the public including the ability to produce water which does not exceed the maximum contaminant levels listed in rule 333-061-0030.

Describe situation that conflicts with the standard. While potholing for the existing water main on 2/19/25, along SW North Dakota St., we discovered that the main we needed to tie into is located just 2 feet from the south edge of the pavement. Due to the hot tap connection and required tapping valve, the new north-to-south main could not achieve the minimum cover requirement, even with vertical bends installed, as the drainage ditch south of the edge of paving causes a significant drop in topography immediately after the connection point. As a result, the cover depth of the new main within the drainage ditch is 17 inches. Please see the attached sketch for reference.

Describe why meeting the standard is highly burdensome or impractical. Meeting the standard is impractical because, even with vertical bends, the main would not meet OAR cover requirements in the ditch due to the connection point's close proximity to the drop-off.

Describe proposed alternate measure that provide adequate protection to public health and safety. To protect the main at shallow cover points, flowable fill was placed above it. TVWD has also documented the issue in our mapping system for correction when the water main that runs along SW North Dakota St. is replaced.



Sarah Alton
C=US, E=sarah.alton@twwd.org, O=Tualatin
Valley Water District, OU=Engineering,
CN=Sarah Alton
2025.03.28 08:06:22-0700'

Signature

3/28/2025

Date

Name Sarah Alton

Address 1850 SW 170th Ave

City/State/Zip Beaverton, OR 97003

Telephone Number 503-848-3033

☐ Comments:

☒ Attachments: 1 - Connection at SW North Dakota St Exhibit

2 - Approved Design Plans for 92nd Ave Main Replacement

Attach plans of proposed waiver request or additional supporting information and

- Email your regulator; or
- Email dws.planreview@dhsosha.state.or.us; or
- Mail:

Oregon Health Authority
Drinking Water Services #640
PO Box 14450
Portland, OR 97293-0450

OHA Use Only

Waiver ID 528-2025

Entered into waiver database ☒

☒ Plan Review Coordinator's notes:

Flowable fill is an acceptable mitigation for the area with less than 30" of cover.

After due consideration the above requested waiver from the construction standards of OAR 333-061-0050 is hereby:

☒ Approved

Comments: the pipe will be encased with CLSM, then rock above to surface to minimize erosion.

☐ Denied



April 3, 2025

Drinking Water Regional Manager Signature
Oregon Health Authority

Date

Waiver database updated ☒

Exhibit 1 - Connection at SW North Dakota St

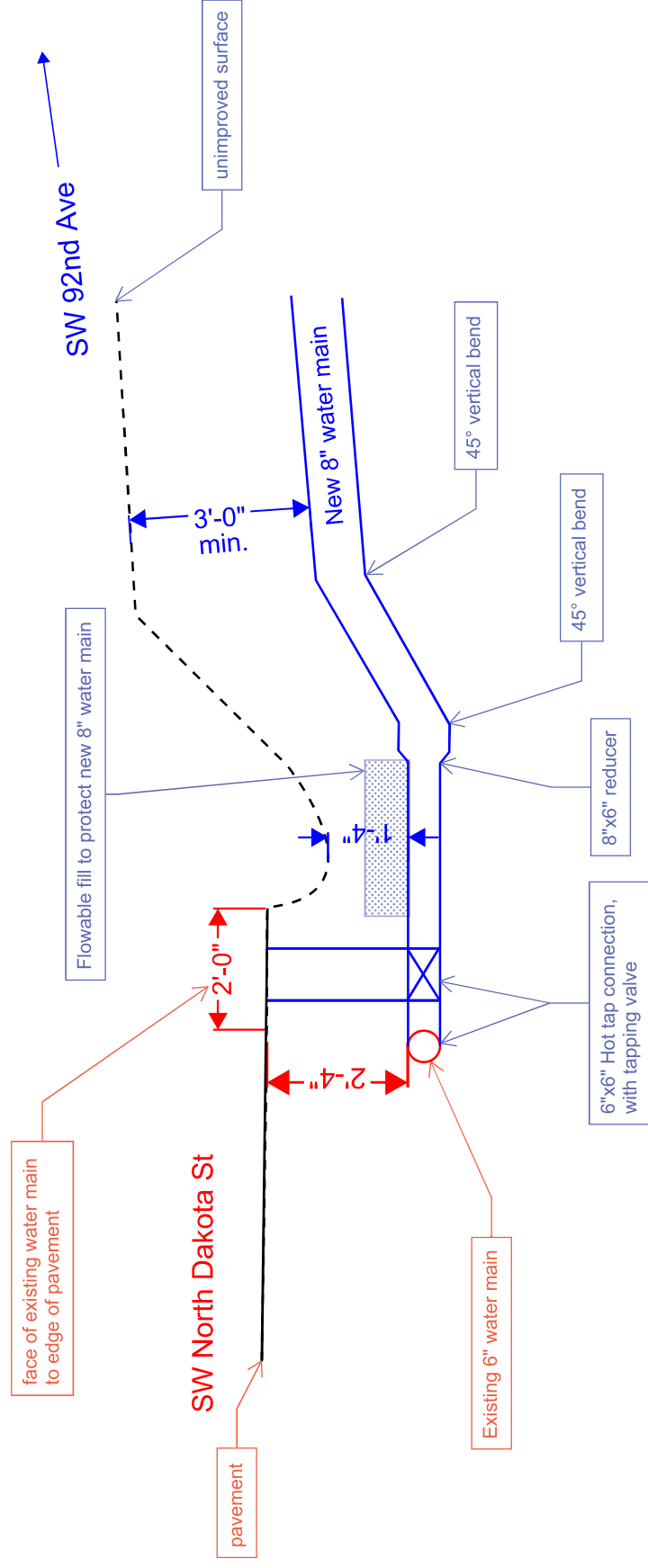

Cross-section looking East at connection point between existing 6" that runs E-W along SW North Dakota St and new 6"/8" that runs N-S along SW 92nd Ave

SW 92nd AVE (GREENBURG TO NORTH DAKOTA) MAIN REPLACEMENT



VICINITY MAP

OPERATING PRESSURE = 80 TO 100 PSI

GENERAL NOTES:

- UTILITY LOCATIONS ARE APPROXIMATE AND MAY VARY FROM MARKINGS IN THE FIELD. UTILITIES SHOWN ON THE DRAWINGS WERE NOT SURVEYED TO ESTABLISH LOCATION. POTHOLE EXISTING UTILITIES AS NEEDED AHEAD OF CONSTRUCTION TO IDENTIFY AND RESOLVE CONFLICTS. COORDINATE WITH ENGINEERING FOR ANY CONFLICTS.
- MAINTAIN MINIMUM 3-FT OF COVER OVER TOP OF PIPE UNLESS OTHERWISE SHOWN ON PLANS OR APPROVED BY ENGINEER.
- ALL UTILITIES INCLUDING SANITARY SEWER AND NATURAL GAS SERVICE LATERALS MAY NOT BE SHOWN. CALL FOR UTILITY LOCATES AND COORDINATE WITH ALL ADJACENT UTILITY OPERATORS PRIOR TO STARTING CONSTRUCTION.
- ALL APPLICABLE EROSION CONTROL MEASURES SHALL BE IN PLACE PRIOR TO THE START OF CONSTRUCTION AND MAINTAINED THROUGHOUT.
- FINAL CONTROL SHALL BE ACCORDING TO CITY OF TIGARD PERMITS.
- FINAL PAVING RESTORATION WILL BE COMPLETED AS PART OF CITY OF TIGARD'S 2024 PAVEMENT REHABILITATION PROJECT (PROJECT #TIG24PMP). MAINTAIN TEMPORARY PAVING UNTIL CITY OF TIGARD'S CONTRACTOR MOBILIZES.
- CORROSION CONTROL SHALL BE INSTALLED PER SPECIFICATIONS ON DRAWINGS. COORDINATE WITH ENGINEERING.
- CLEAN, PRESSURE TEST, AND DISINFECT WATER SYSTEM COMPONENTS PER DISTRICT, AWWA, AND OHA STANDARDS.
- TRANSFER EXISTING WATER SERVICES TO NEW MAIN AFTER DISINFECTION OF THE NEW WATER PIPE AND NEW SERVICES ARE COMPLETED AND APPROVED. ABANDON MAINS AT THE TEE OR AS SPECIFIED ON DRAWINGS. COORDINATE WITH ENGINEERING AND DRC.
- MAINTAIN REQUIRED SPACING FROM SANITARY SEWER SYSTEM. NEW WATER MAIN SHALL BE 10 FEET OFFSET FROM SANITARY SEWER LINES, OR 5 FEET HORIZONTAL WITH A 1.5 FOOT VERTICAL SEPARATION ABOVE SANITARY SEWER LINES PER OAR 333-61-0050.

NOTICE TO EXCAVATORS

ATTENTION: OREGON LAW REQUIRES YOU TO FOLLOW RULES ADOPTED BY THE OREGON UTILITY LOCATION COUNCIL (OULC). THESE RULES ARE SET FORTH IN OAR 93-005-0010 THROUGH OAR 93-005-0080. YOU MAY OBTAIN COPIES OF THE RULES BY CALLING THE CENTER.
(NOTE: THE TELEPHONE NUMBER FOR THE OREGON UTILITY LOCATION CENTER IS 303-532-1857).

POTENTIAL UNDERGROUND FACILITY OWNERS

dig safely.

Call the Oregon One-Call Center
DIAL 811 or 1-800-332-2344

EMERGENCY TELEPHONE NUMBERS

NW NATURAL GAS 503-229-4211 Ext 4313
1447 7am-6pm
PGE 503-255-4643
CENTURYLINK 503-261-7400
COMCAST CABLE 503-261-7400
VERIZON 1-800-433-1000

CONST. TICKET #:

LEGEND & SYMBOLOLOGY

- RIGHT OF WAY LINE
PROPERTY LINE
GAS LINE (ACTIVE)
GAS LINE (PLANNED ABANDONMENT IN JAN. 2025)
SIDEWALK
STORM SEWER
SANITARY SEWER
TELEVISION/CABLE
FIBER OPTIC LINE
ELECTRIC POWER
CITY OF TIGARD WATER (EXISTING)
CITY OF TIGARD PAVEMENT REHABILITATION LIMITS
CITY OF TIGARD DRIVEWAY REHABILITATION LIMITS
CITY OF TIGARD PROPOSED AC DRAINAGE CURB
TOWN WATER (EXISTING, TO REMAIN)
TOWN WATER (NEW)
GATE VALVE (EXIST)
GATE VALVE (NEW)
FIRE HYDRANT (EXIST)
FIRE HYDRANT (NEW)
BLOW OFF (EXIST)
PHASE END ASSEMBLY (NEW)
CARV (EXIST)
CARV (NEW)
REDUCER (EXIST)
REDUCER (NEW)
WATER METER
SAMPLE STATION
CATCH BASIN
POWER POLE
LIGHT POLE
SEWER MANHOLE
STORM MANHOLE
COMMUNICATION MANHOLE
GAS VALVE

SHEET NO	SHEET DESCRIPTION
T1	TITLE SHEET AND VICINITY MAP
C1	WATER PLAN - SW 92nd AVE STA 1+00 TO STA 2+65
C2	WATER PLAN - SW 92nd AVE STA 2+65 TO STA 4+87
C3	WATER PLAN - SW 92nd AVE STA 4+87 TO STA 7+36
C4	WATER PLAN - SW 92nd AVE STA 7+36 TO STA 9+71
C5	WATER PLAN - SW 92nd AVE STA 9+71 TO STA 11+39
D1	STANDARD DETAILS

ABBREVIATIONS:

AC ASPHALT CONCRETE PAVEMENT
BFV BUTTERFLY VALVE
BO BLOWOFF
COMB COMBINATION AIR/VACUUM RELIEF VALVE
CTR CENTER
DEPT DEPARTMENT
DET DETAIL
DIP DUCTILE IRON PIPE
DWG DRAWING
EA EACH
EL ELEVATION
EXTG EXISTING
FLG FLANGE
FT FOOT
GAS GAS LINE
GV GATE VALVE
HYD HYDRANT
ME MECHANICAL JOINT
MIN MINIMUM
ODOT OREGON DEPARTMENT OF TRANSPORTATION
S SANITARY SEWER
SIDEWALK SIDEWALK
ST STORM SEWER
STD STANDARD
TB THRUST BLOCK
TYP TYPICAL
TV TELEVISION
W WATER

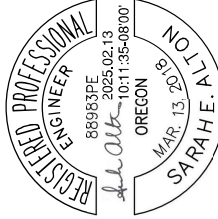

EXPIRES: 12-31-2025

REV	NO CHANGES	DESCRIPTION	BY	DATE	CHKD	APPR	DATE
1			MAC	02/26	SA		11/24
2							
3							
4							
5							
6							
7							
8							
9							
10							

REVISIONS



TUALATIN VALLEY
WATER DISTRICT

SW 92nd AVE/GREENBURG MAIN REPLACEMENT
COVER SHEET AND VICINITY MAP

DATE	01/05/2025
PROJECT NO.	E8487
ACCT. NO.	C12913
SHEET NO.	1 OF 7
DWG. NO.	T1

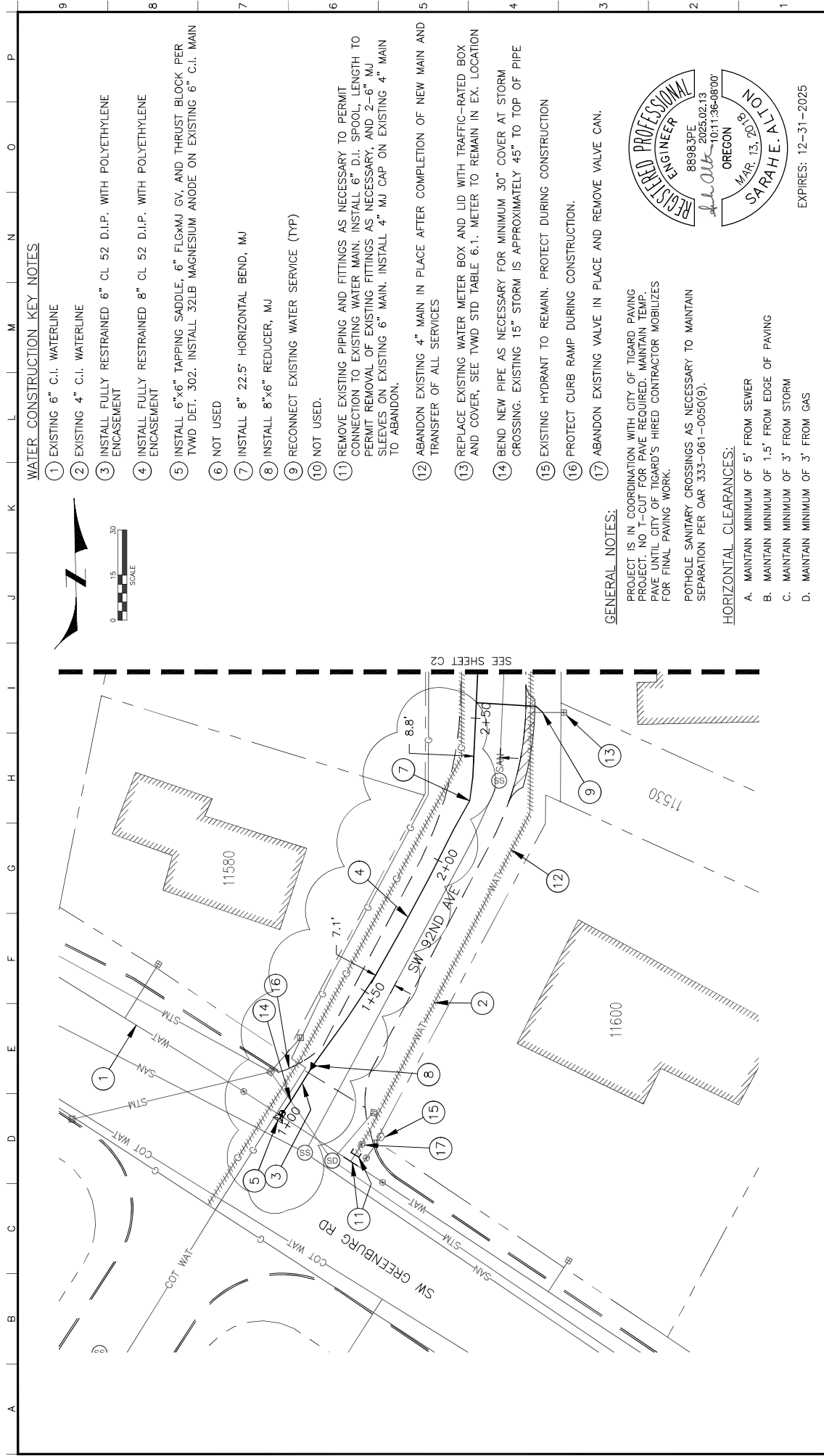

WATER CONSTRUCTION KEY NOTES

- 1 EXISTING 6" C.I. WATERLINE
- 2 EXISTING 4" C.I. WATERLINE
- 3 INSTALL FULLY RESTRAINED 6" CL 52 D.I.P. WITH POLYETHYLENE ENCASEMENT
- 4 INSTALL FULLY RESTRAINED 8" CL 52 D.I.P. WITH POLYETHYLENE ENCASEMENT
- 5 INSTALL 6"x6" TAPPING SADDLE, 6" FLGxMJ GV, AND THRUST BLOCK PER TWD DET. 302. INSTALL 32LB MAGNESIUM ANODE ON EXISTING 6" C.I. MAIN
- 6 NOT USED
- 7 INSTALL 8" 22.5° HORIZONTAL BEND, MJ
- 8 INSTALL 8"x6" REDUCER, MJ
- 9 RECONNECT EXISTING WATER SERVICE (TYP)
- 10 NOT USED.
- 11 REMOVE EXISTING PIPING AND FITTINGS AS NECESSARY TO PERMIT CONNECTION TO EXISTING WATER MAIN. INSTALL 6" D.I. SPOOL, LENGTH TO PERMIT REMOVAL OF EXISTING FITTINGS AS NECESSARY, AND 2-6" MJ SLEEVES ON EXISTING 6" MAIN. INSTALL 4" MJ CAP ON EXISTING 4" MAIN TO ABANDON.
- 12 ABANDON EXISTING 4" MAIN IN PLACE AFTER COMPLETION OF NEW MAIN AND TRANSFER OF ALL SERVICES
- 13 REPLACE EXISTING WATER METER BOX AND LID WITH TRAFFIC-RATED BOX AND COVER, SEE TWD STD TABLE 6.1. METER TO REMAIN IN EX. LOCATION
- 14 BEND NEW PIPE AS NECESSARY FOR MINIMUM 30" COVER AT STORM CROSSING. EXISTING 15" STORM IS APPROXIMATELY 45" TO TOP OF PIPE
- 15 EXISTING HYDRANT TO REMAIN. PROTECT DURING CONSTRUCTION
- 16 PROTECT CURB RAMP DURING CONSTRUCTION.
- 17 ABANDON EXISTING VALVE IN PLACE AND REMOVE VALVE CAN.

GENERAL NOTES:

PROJECT IS IN COORDINATION WITH CITY OF TIGARD PAVING PROJECT. NO T-CUT FOR PAVE REQUIRED. MAINTAIN TEMP. PAVE UNTIL CITY OF TIGARD'S HIRED CONTRACTOR MOBILIZES FOR FINAL PAVING WORK.

POTHOLE SANITARY CROSSINGS AS NECESSARY TO MAINTAIN SEPARATION PER OAR 333-061-0050(9).

HORIZONTAL CLEARANCES:

- A. MAINTAIN MINIMUM OF 5' FROM SEWER
- B. MAINTAIN MINIMUM OF 1.5' FROM EDGE OF PAVING
- C. MAINTAIN MINIMUM OF 3' FROM STORM
- D. MAINTAIN MINIMUM OF 3' FROM GAS

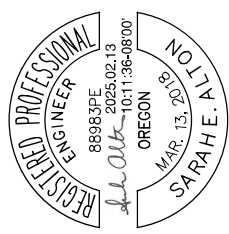

EXPIRES: 12-31-2025

		SW 92nd AVE/GREENBURG MAIN REPLACEMENT		DATE: 01/05/2025	
		SW 92nd AVE PLAN STA 1+00 TO 2+65		PROJECT NO: E8487	
REVISIONS		REV	DESCRIPTION	BY	DATE
		1	REMOVED HORIZ. BEND FOR CONNECTION TO EX.	MAC	02/25/24
		SA	DATE	CHK'D	APPR
		DESIGNED	MAC	DATE: 11/24	
		DRAWN	MAC	DATE: 11/24	
		CHECKED	SA	DATE: 01/25	
		APPROVED	SA	DATE: 01/25	

PROJECT NO.	E8487
ACCT. NO.	C12913
SHEET NO.	2 OF 7
DWG. NO.	C1

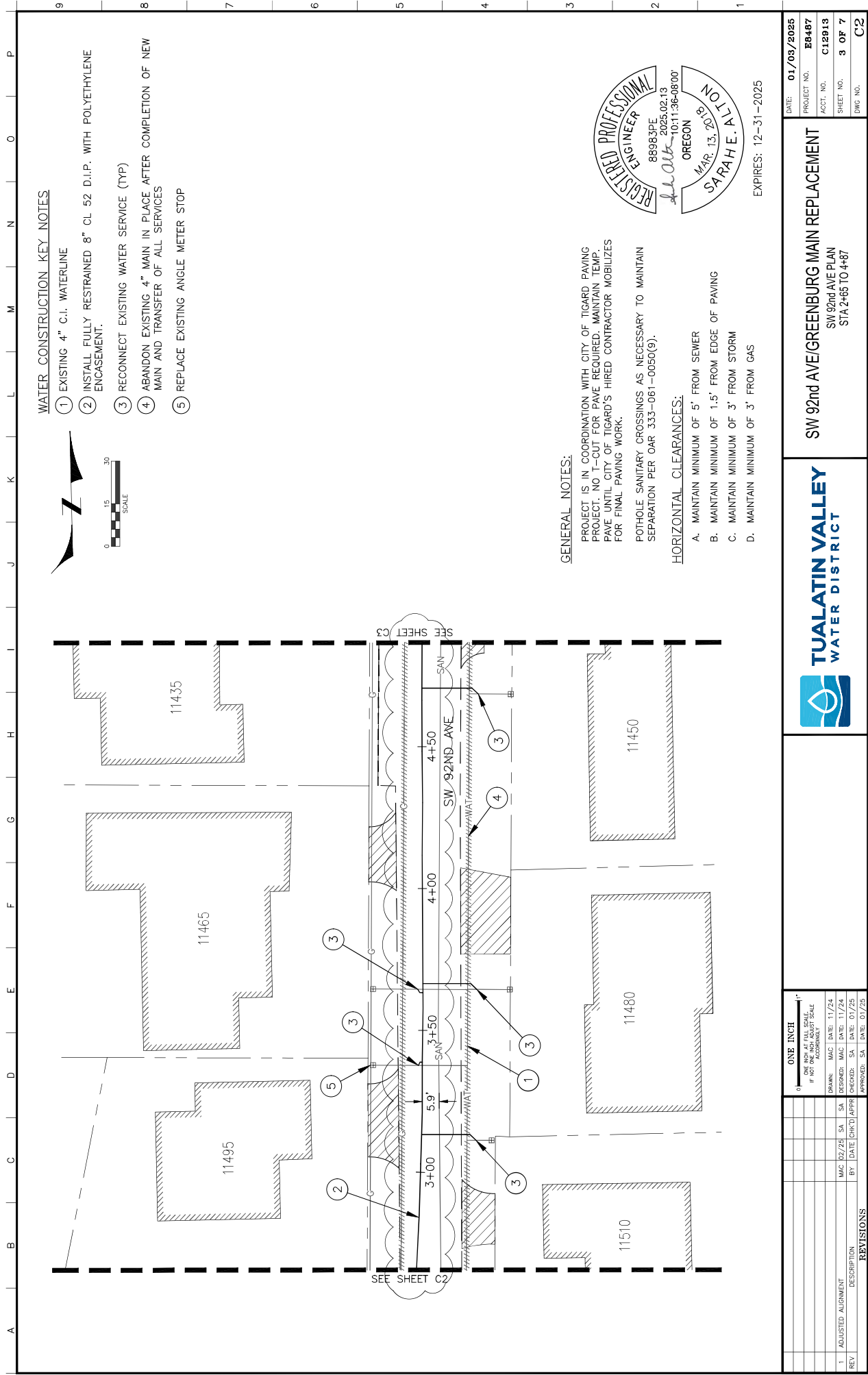

WATER CONSTRUCTION KEY NOTES

- 1 EXISTING 4" C.I. WATERLINE
- 2 INSTALL FULLY RESTRAINED 8" CL 52 D.I.P. WITH POLYETHYLENE ENCASEMENT.
- 3 RECONNECT EXISTING WATER SERVICE (TYP)
- 4 ABANDON EXISTING 4" MAIN IN PLACE AFTER COMPLETION OF NEW MAIN AND TRANSFER OF ALL SERVICES
- 5 REPLACE EXISTING ANGLE METER STOP

GENERAL NOTES:

PROJECT IS IN COORDINATION WITH CITY OF TIGARD PAVING PROJECT. NO T-CUT FOR PAVE REQUIRED. MAINTAIN TEMP. PAVE UNTIL CITY OF TIGARD'S HIRED CONTRACTOR MOBILIZES FOR FINAL PAVING WORK.

POT HOLE SANITARY CROSSINGS AS NECESSARY TO MAINTAIN SEPARATION PER OAR 333-061-0050(9).

HORIZONTAL CLEARANCES:

- A. MAINTAIN MINIMUM OF 5' FROM SEWER
- B. MAINTAIN MINIMUM OF 1.5' FROM EDGE OF PAVING
- C. MAINTAIN MINIMUM OF 3' FROM STORM
- D. MAINTAIN MINIMUM OF 3' FROM GAS

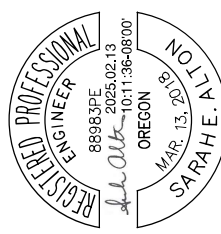

EXPIRES: 12-31-2025

																				TUALATIN VALLEY WATER DISTRICT										SW 92nd AVE/GREENBURG MAIN REPLACEMENT										DATE: 01/05/2025									
																														PROJECT NO. EB487										DATE: 01/05/2025									
																														ACT. NO. C12913										PROJECT NO. EB487									
																														SHEET NO. 3 OF 7										ACT. NO. C12913									
																														DWG NO. C-2										SHEET NO. 3 OF 7									
																														SW 92nd AVE PLAN										DWG NO. C-2									
																														STA 2+65 TO 4+87										SW 92nd AVE PLAN									
																														ONE INCH = 10 FEET										STA 2+65 TO 4+87									
																														DATE: 01/25										DATE: 01/25									
																														APPROVED: SA										DATE: 01/25									
																														CHECKED: SA										DATE: 01/25									
																														BY DATE										DATE: 01/25									
																														MAC 02/25										DATE: 11/24									
																														SA										DATE: 11/24									
																														DESIGNED: MAC										DATE: 11/24									
																														DRAWN: MAC										DATE: 11/24									
																														ONE INCH = 10 FEET SCALE										DATE: 11/24									
																														0										DATE: 11/24									
																														ONE INCH = 10 FEET SCALE										DATE: 11/24									
																														IF NOT TO SCALE										DATE: 11/24									
																														ACROSSROADS										DATE: 11/24									
																														ADJUSTED ALIGNMENT										DATE: 11/24									
																														1										DATE: 11/24									
																														REV										DATE: 11/24									
																														DESCRIPTION										DATE: 11/24									
																														REVISIONS										DATE: 11/24									

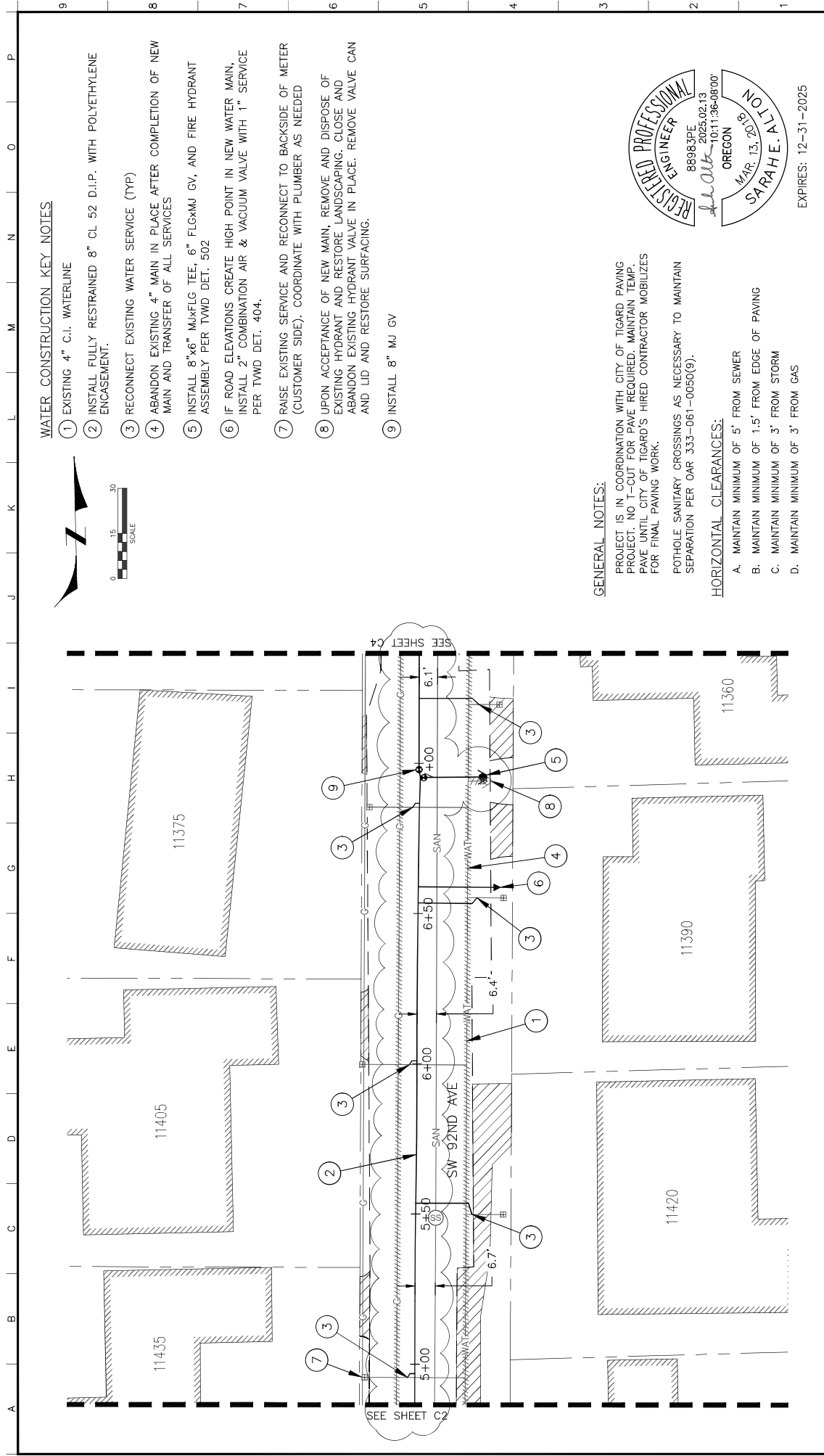

WATER CONSTRUCTION KEY NOTES

- 1 EXISTING 4" C.I. WATERLINE
- 2 INSTALL FULLY RESTRAINED 8" CL 52 D.I.P. WITH POLYETHYLENE ENCASEMENT.
- 3 RECONNECT EXISTING WATER SERVICE (TYP)
- 4 ABANDON EXISTING 4" MAIN IN PLACE AFTER COMPLETION OF NEW MAIN AND TRANSFER OF ALL SERVICES
- 5 INSTALL 8"x8" MUXFLG TEE, 6" FLGxMJ GV, AND FIRE HYDRANT ASSEMBLY PER TWD DET. 502
- 6 IF ROAD ELEVATIONS CREATE HIGH POINT IN NEW WATER MAIN, INSTALL 2" COMBINATION AIR & VACUUM VALVE WITH 1" SERVICE PER TWD DET. 404.
- 7 RAISE EXISTING SERVICE AND RECONNECT TO BACKSIDE OF METER (CUSTOMER SIDE). COORDINATE WITH PLUMBER AS NEEDED
- 8 UPON ACCEPTANCE OF NEW MAIN, REMOVE AND DISPOSE OF EXISTING HYDRANT AND RESTORE LANDSCAPING. CLOSE AND ABANDON EXISTING HYDRANT VALVE IN PLACE. REMOVE VALVE CAN AND LID AND RESTORE SURFACING.
- 9 INSTALL 8" MJ GV

GENERAL NOTES:

PROJECT IS IN COORDINATION WITH CITY OF TIGARD PAVING PROJECT. NO T-CUT FOR PAVE REQUIRED. MAINTAIN TEMP. PAVE UNTIL CITY OF TIGARD'S HIRED CONTRACTOR MOBILIZES FOR FINAL PAVING WORK.

POT HOLE SANITARY CROSSINGS AS NECESSARY TO MAINTAIN SEPARATION PER OAR 333-061-0050(9).

HORIZONTAL CLEARANCES:

- A. MAINTAIN MINIMUM OF 5' FROM SEWER
- B. MAINTAIN MINIMUM OF 1.5' FROM EDGE OF PAVING
- C. MAINTAIN MINIMUM OF 3' FROM STORM
- D. MAINTAIN MINIMUM OF 3' FROM GAS

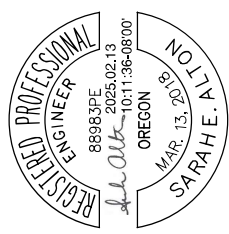

EXPIRES: 12-31-2025

		SW 92nd AVE/GREENBURG MAIN REPLACEMENT		DATE: 01/05/2025	
		SW 92nd AVE PLAN STA 4+87 TO 7+36		PROJECT NO. E8487	
REVISIONS		BY DATE [CHK'D] APPR		SHEET NO. 4 OF 7	
		DESCRIPTION		DWG NO. C-3	
1	MOVED HYDRANT, ADJUSTED ALIGNMENT	MAC	02/25	SA	11/24
2		MAC	02/25	SA	11/24
3		MAC	02/25	SA	11/24
4		MAC	02/25	SA	11/24
5		MAC	02/25	SA	11/24
6		MAC	02/25	SA	11/24
7		MAC	02/25	SA	11/24
8		MAC	02/25	SA	11/24
9		MAC	02/25	SA	11/24

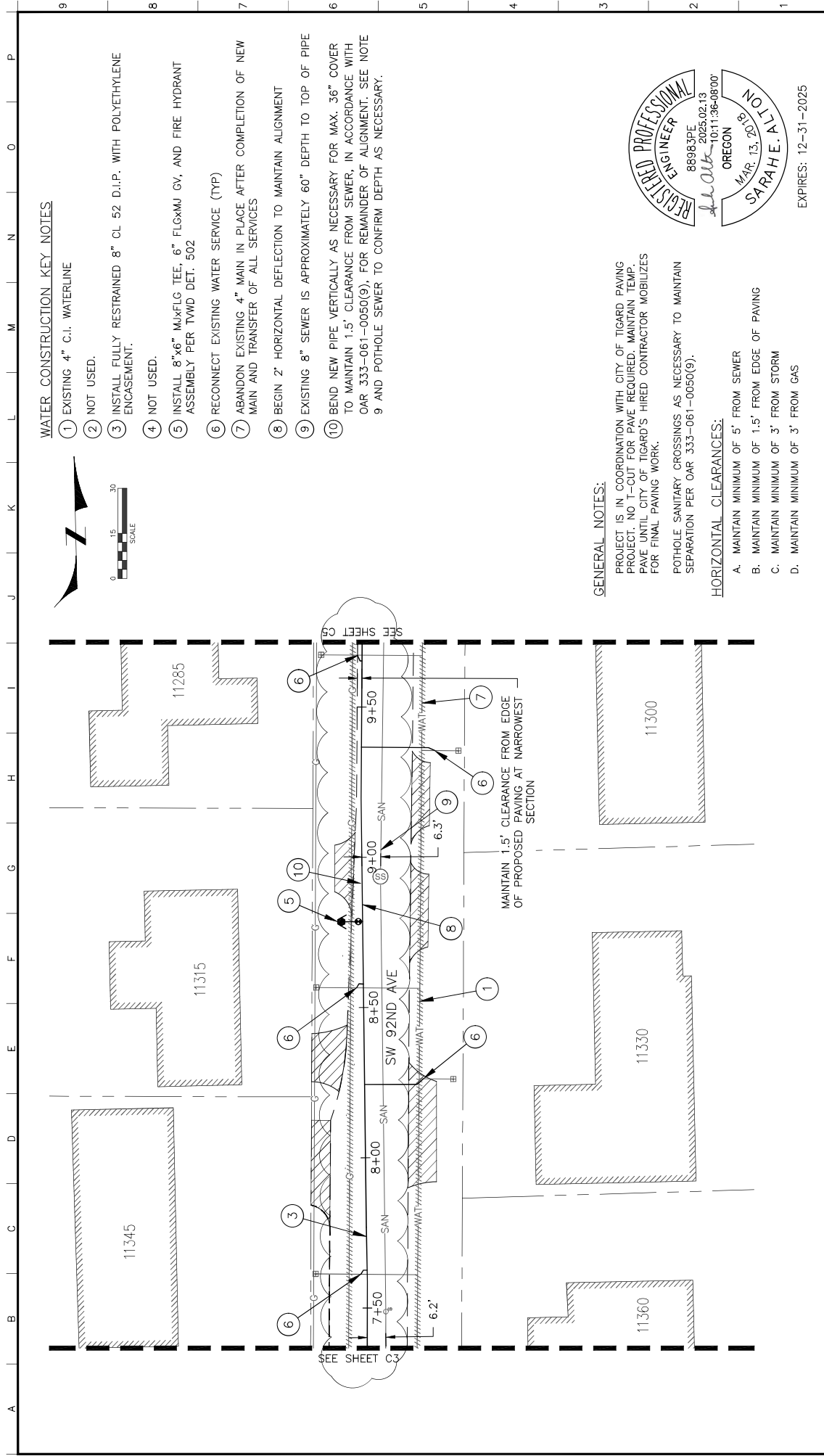

WATER CONSTRUCTION KEY NOTES

- 1 EXISTING 4" C.I. WATERLINE
- 2 NOT USED.
- 3 INSTALL FULLY RESTRAINED 8" CL 52 D.I.P. WITH POLYETHYLENE ENCASEMENT.
- 4 NOT USED.
- 5 INSTALL 8"x6" MUXFLG TEE, 6" FLGxMJ GV, AND FIRE HYDRANT ASSEMBLY PER TWD DET. 502
- 6 RECONNECT EXISTING WATER SERVICE (TYP)
- 7 ABANDON EXISTING 4" MAIN IN PLACE AFTER COMPLETION OF NEW MAIN AND TRANSFER OF ALL SERVICES
- 8 BEGIN 2' HORIZONTAL DEFLECTION TO MAINTAIN ALIGNMENT
- 9 EXISTING 8" SEWER IS APPROXIMATELY 60" DEPTH TO TOP OF PIPE
- 10 BEND NEW PIPE VERTICALLY AS NECESSARY FOR MAX. 36" COVER TO MAINTAIN 1.5' CLEARANCE FROM SEWER, IN ACCORDANCE WITH OAR 333-061-0050(9), FOR REMAINDER OF ALIGNMENT. SEE NOTE 9 AND POT HOLE SEWER TO CONFIRM DEPTH AS NECESSARY.

GENERAL NOTES:

PROJECT IS IN COORDINATION WITH CITY OF TIGARD PAVING PROJECT. NO T-CUT FOR PAVE REQUIRED. MAINTAIN TEMP. PAVE UNTIL CITY OF TIGARD'S HIRED CONTRACTOR MOBILIZES FOR FINAL PAVING WORK.

POT HOLE SANITARY CROSSINGS AS NECESSARY TO MAINTAIN SEPARATION PER OAR 333-061-0050(9).

HORIZONTAL CLEARANCES:

- A. MAINTAIN MINIMUM OF 5' FROM SEWER
- B. MAINTAIN MINIMUM OF 1.5' FROM EDGE OF PAVING
- C. MAINTAIN MINIMUM OF 3' FROM STORM
- D. MAINTAIN MINIMUM OF 3' FROM GAS

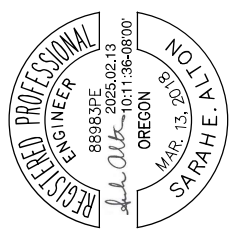

EXPIRES: 12-31-2025

																				TUALATIN VALLEY WATER DISTRICT										SW 92nd AVE/GREENBURG MAIN REPLACEMENT SW 92nd AVE PLAN STA 7+36 TO 9+71										DATE: 01/03/2025 PROJECT NO. E8487 ACT. NO. C12913 SHEET NO. 5 OF 7 DWG NO. C4																																																																																																																																																																																																																																																																																																																																																																																																																																																																																																																																																																																																																																																																																																																																																																																																																																																																																																																																																																																																																																																																																																																																																																																																																																																																																																																																																																																																																																																																																																																																																																																																																																																																																																																																																																																																																																																																																																																																																																																																																																																																																																																																																																																																																																																																																																																																																																																																																																																																																																																																																																																																																																																																																																																																																																																																																																																																																																																																																																																																																																																																																																																																																																																																																																																																																																																																																																																																																																																																																																																																																																																																																																																																																																																																																																																																																																																																																																																																																																																																																																																																																																																																																																																																																																																																																																																																																																																																																																																																																																																																																																																																																																																																																																																																																																																																																																																																																																																																																																																																																																																																																																																																																																																																																																																																																																																																																																																																																																			
																														ONE INCH = 1" ONE INCH AT FULL SCALE. IF NOT SPECIFIED, SCALE ACCORDINGLY										DRAWN: MAC DATE: 11/24 DESIGNER: SA DATE: 11/24 CHECKED: SA DATE: 01/25 APPROVED: SA DATE: 01/25																																																																																																																																																																																																																																																																																																																																																																																																																																																																																																																																																																																																																																																																																																																																																																																																																																																																																																																																																																																																																																																																																																																																																																																																																																																																																																																																																																																																																																																																																																																																																																																																																																																																																																																																																																																																																																																																																																																																																																																																																																																																																																																																																																																																																																																																																																																																																																																																																																																																																																																																																																																																																																																																																																																																																																																																																																																																																																																																																																																																																																																																																																																																																																																																																																																																																																																																																																																																																																																																																																																																																																																																																																																																																																																																																																																																																																																																																																																																																																																																																																																																																																																																																																																																																																																																																																																																																																																																																																																																																																																																																																																																																																																																																																																																																																																																																																																																																																																																																																																																																																																																																																																																																																																																																																																																																																																																																																																																																																			

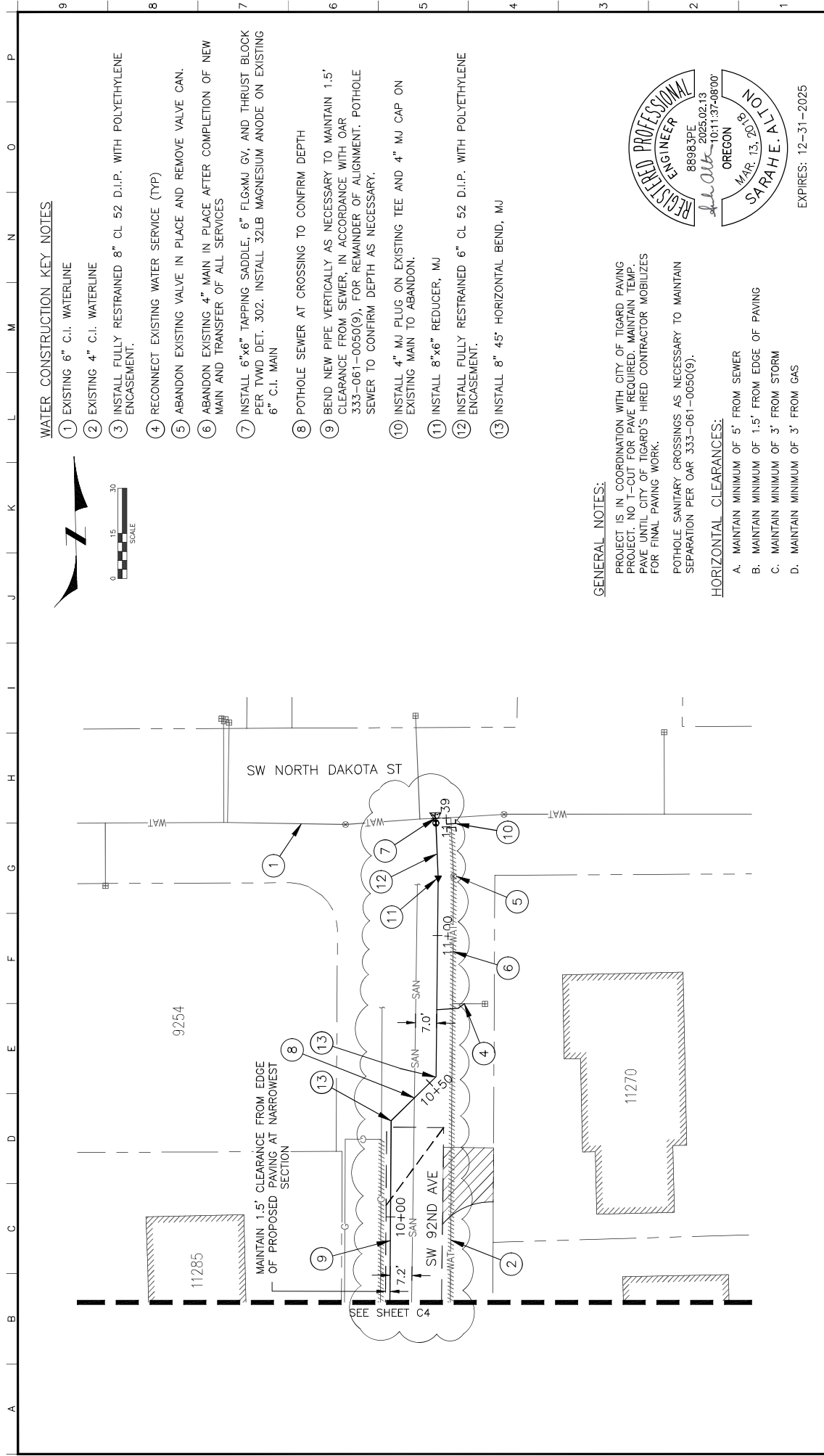

WATER CONSTRUCTION KEY NOTES

- ① EXISTING 6" C.I. WATERLINE
- ② EXISTING 4" C.I. WATERLINE
- ③ INSTALL FULLY RESTRAINED 8" CL 52 D.I.P. WITH POLYETHYLENE ENCASEMENT.
- ④ RECONNECT EXISTING WATER SERVICE (TYP)
- ⑤ ABANDON EXISTING VALVE IN PLACE AND REMOVE VALVE CAN.
- ⑥ ABANDON EXISTING 4" MAIN IN PLACE AFTER COMPLETION OF NEW MAIN AND TRANSFER OF ALL SERVICES
- ⑦ INSTALL 6"x6" TAPPING SADDLE, 6" FLG&MJ GV, AND THRUST BLOCK PER TYWD DET. 302. INSTALL 32LB MAGNESIUM ANODE ON EXISTING 6" C.I. MAIN
- ⑧ POTHOLE SEWER AT CROSSING TO CONFIRM DEPTH
- ⑨ BEND NEW PIPE VERTICALLY AS NECESSARY TO MAINTAIN 1.5' CLEARANCE FROM SEWER, IN ACCORDANCE WITH OAR 333-061-0050(9), FOR REMAINDER OF ALIGNMENT. POTHOLE SEWER TO CONFIRM DEPTH AS NECESSARY.
- ⑩ INSTALL 4" MJ PLUG ON EXISTING TEE AND 4" MJ CAP ON EXISTING MAIN TO ABANDON.
- ⑪ INSTALL 8"x6" REDUCER, MJ
- ⑫ INSTALL FULLY RESTRAINED 6" CL 52 D.I.P. WITH POLYETHYLENE ENCASEMENT.
- ⑬ INSTALL 8" 45° HORIZONTAL BEND, MJ

GENERAL NOTES:

PROJECT IS IN COORDINATION WITH CITY OF TIGARD PAVING PROJECT. NO T-CUT FOR PAVE REQUIRED. MAINTAIN TEMP. PAVE UNTIL CITY OF TIGARD'S HIRED CONTRACTOR MOBILIZES FOR FINAL PAVING WORK.

POTHOLE SANITARY CROSSINGS AS NECESSARY TO MAINTAIN SEPARATION PER OAR 333-061-0050(9).

HORIZONTAL CLEARANCES:

- A. MAINTAIN MINIMUM OF 5' FROM SEWER
- B. MAINTAIN MINIMUM OF 1.5' FROM EDGE OF PAVING
- C. MAINTAIN MINIMUM OF 3' FROM STORM
- D. MAINTAIN MINIMUM OF 3' FROM GAS

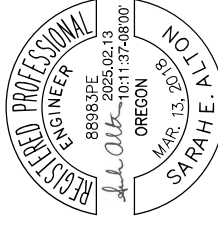

EXPIRES: 12-31-2025

DATE: 01/05/2025				PROJECT NO. E8487			
ACCT. NO. C12913				SHEET NO. 8 OF 7			
DWG. NO. C5							
TUALATIN VALLEY WATER DISTRICT				SW 92nd AVE MAIN REPLACEMENT			
				SW 92nd AVE PLAN			
				STA 9+71 TO 11+39			

